



**FACTORY DIRECT**  
— F L O O R I N G —

Aqua Plank & Tile  
Ultra 5G  
**Installation  
& Care Guide**

**IMPORTANT NOTES ABOUT YOUR FLOORING. READ BEFORE INSTALLING**

# Care Guide

## Acclimatization and Storage

Your new flooring has to be acclimatized for 24 hours before installation begins. The flooring must remain in its packaging stored horizontal in the room, which it is to be installed into. Please Note the room must be between 18° and 24°, room conditions should never exceed 50° or fall below 10°.

## Subfloor

It is of the utmost importance that the subfloor is dry, clean, solid and flat. You can find appropriate electronic moisture meters in DIY stores, the subfloor must be flat and the flatness tolerances must be observed. The installer must always and in particular with renovation work check the current status of the subfloor, if it does not meet the requirements stated here extra work will need to be carried out to level the subfloor out, to determine the flatness of your floor apply these tolerances over 3m length the floor must not be more than 3mm difference.

## Underfloor Heating

We can recommend water based underfloor heating systems be used with Aqua Plank Ultra flooring with a temperature not exceeding 27°C and an average running of 20°C. The heating must be turned off 48hrs prior to installation and once the flooring has been installed turned on with an increase in working temperature of 5°C per day until normal operating temperature has been reached. Water Based heating pipes are to be fitted a minimum of 30mm below the subfloor surface and electric based cables and grids a minimum of 10mm.

## Tools

Having the correct tools and equipment and understanding of how to use them safely is key to a successful installation, Broom and or a vacuum cleaner, tape measure, pencil, set square, ruler, utility knife, hand roller, rubber mallet and a tapping block.

## Expansion

Depending on the climate conditions your flooring will expand or contract, it therefore needs to be kept a suitable distance away from any fixed structures such as walls, supports, door frames, radiator pipes etc., this is called the expansion gap. This gap should be a minimum of 8mm, for areas larger than 60m<sup>2</sup> it is recommended to increase this minimum size to a 10mm gap, if the run of a single wall exceeds 20 linear metres then expansion profiles must be used.

### PLEASE NOTE

All flooring will CHIP, DENT and SCRATCH unless care is taken to PROTECT it, FELT PADS should be used on all moveable furniture. Matting at room entrances will greatly reduce grit and dirt from being transferred onto your flooring.

Liability for the installation remains with the installer following the fitting instructions and guides supplied and ensuring that the product and area are both suitable to be installed.

Prevent the flooring from coming into contact with a large amount of water, or from being submerged as the click connection is not waterproof.

Conservatories and rooms with excessive light should be avoided unless protection screens are used, this can be glass protection or blinds.

Always inspect materials for faults or damage as no claims on surface defects can be accepted after installation.



**FACTORY DIRECT**  
FLOORING

# Installation Guide

## 5G Installation Instructions

The subfloor should be clean dry and flat, remove any dirt, paint, wax, oil or any contaminants before you begin the installation.

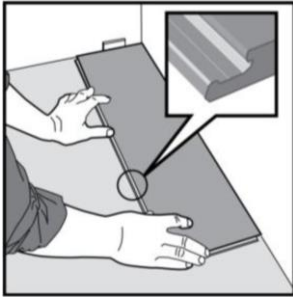

**1.** Starting from the left-hand side of the room, with the tongue of the board facing the room, allow an expansion gap of approximately 8mm

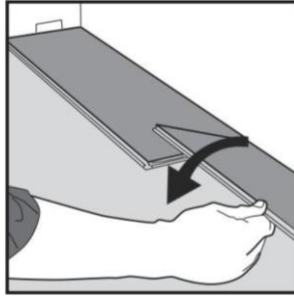

**2.** Place the 2nd plank tight to the end of plank 1, in a single action fold down the 2nd plank making sure the panels are tight against each other.

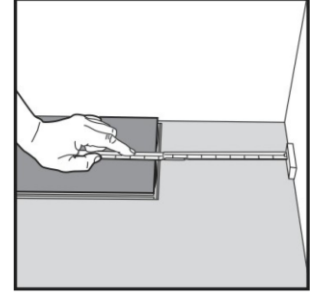

**3.** After the row has been built up, the final plank can be installed, measure the distance required allowing again for the 8mm expansion gap.

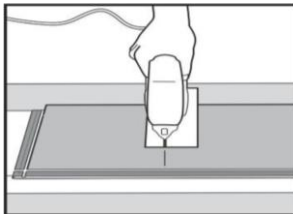

**4.** The panels can be cut using a jigsaw place the panel face down to avoid splinters, if using a handsaw cut with the face up.

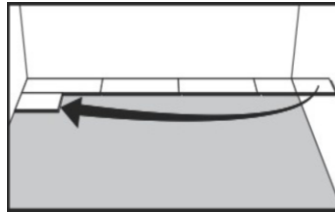

**5.** The balance from the last plank of row 1 can be used to start row 2, if the distance is a minimum of 500mm.



**6.** The minimum distance between end placement of the planks is recommended not to be less than 400mm.

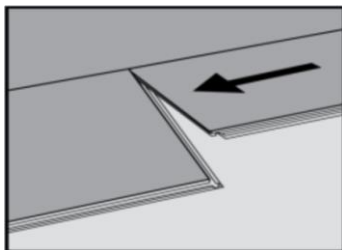

**7.** The 2nd plank of the 2nd row is located into the 1st row and gently slid up to the end of the 1st plank in row 2 at a slight angle.

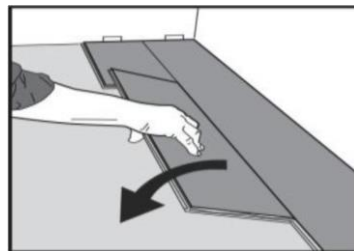

**8.** Using the same method and in a single action fold down to locate the planks, use small amount of pressure to ensure the planks are tightly together.

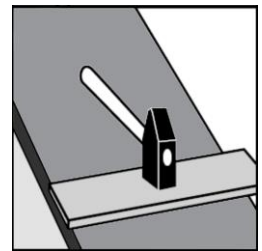

**9.** If required press or tap lightly along the short end of the panel.



**FACTORY DIRECT**  
FLOORING

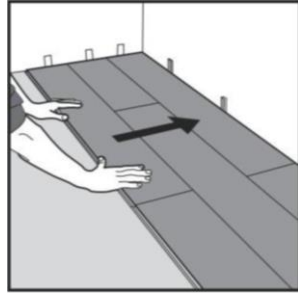

**10.** After you have constructed 3 rows, adjust the expansion gap to around 8mm, for areas larger than 10m in length or width its recommended to include an intermediate expansion of 10mm.

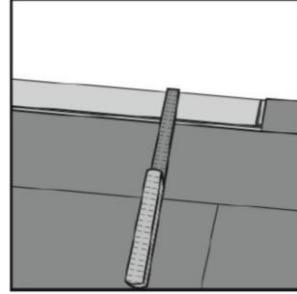

**11.** The last row must also have an expansion allowance of 8mm and the plank width must be a minimum of 50mm excluding the expansion.

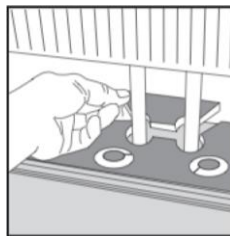
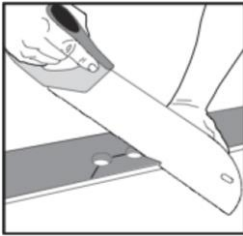

**12.** When installing around radiator pipes ensure an expansion allowance is left, this can be covered with the use of pipe covers.

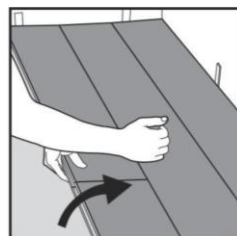

**13.** When disassembling separate the whole row this can be done by lifting up slightly and giving a slight tap just above the horizontal side joint. Once the whole row has been released the panels can be slid horizontally to separate DO NOT fold up.

**WARNING!** If the joint is not lined up correctly and a forced attempt is made to click the joint together permanent damage to the profile may occur!



**FACTORY DIRECT**  
FLOORING

# Aftercare

## How to Care for Your Floor

1. Remove all loose dirt and debris from the flooring by using a vacuum cleaner, broom or a dust pan and brush, electro static wipes, if you are using a vacuum cleaner please refer to the manufacturers guidelines and make sure that it will be suitable for cleaning aqua plank flooring.

2. We recommend that only PH Neutral cleaners and disinfectants are used during the cleaning of your new floor, try to remove spills as soon as they arrive on the floor and rinse down with warm clean water, please be aware no flooring product will be impervious to every chemical or solvent and to avoid rubber and petroleum based products such as tyres, casters, floors mats and asphalt sealers which may contain chemicals that could react and permanently stain your floor.

3. We recommend fitting a suitable non-rubber backed doormat as this can prevent up to 80% of tracked in dirt debris.

4. Avoid swamping the floor area with detergent and rinse water, take care to remove all liquids off the surface as re-deposited rinse water with dirt and detergent can settle on the surface and give a hazy appearance.

### HELPFUL TIPS

Avoid dragging or sliding heavy items of furniture, carousels and point of sale across the floor.

Spending a small amount of time looking after your new click vinyl floor will ensure that it continues to look at its best and provide you with many years of carefree use without the need of costly maintenance and repairs.

Never use abrasive cleaners or scourers

Never use waxes or floor polishes during cleaning

DO USE MOP AND WATER FOR CLEANING

DO USE DRIP TRAYS UNDERNEATH POT PLANTS

DO USE PH NEUTRAL CLEANERS

DO REMOVE ANY SPILLS OR EXCESSIVE LIQUIDS

AS SOON AS THEY OCCUR



**FACTORY DIRECT**  
— F L O O R I N G —





# ENGINEERED RIGID LVT

PREMIUM LUXURY CLICK VINYL FLOORING

**aquaplank**



**FACTORY DIRECT**  
— FLOORING —

# ENGINEERED RIGID LVT

## PREMIUM LUXURY CLICK VINYL FLOORING

With the continued growth of LVT and Interlocking Vinyl Tiles, we felt now was the perfect time to introduce an Engineered Vinyl Flooring collection to our range. This brief document will guide you through everything you need to know about the exclusive new Aqua Plank Ultra collection.

Aqua Plank Ultra has been expertly engineered to provide a premium rigid construction. It benefits from exceptional stability, making it an ideal choice for laying over existing floor coverings. The floors come with a unique 5G locking system, enabling them to be fitted quickly and easily, without the need for adhesive. This makes it very easy to install, even for those with no prior floor fitting experience.

The floors have been constructed via extensive research, in order to provide a balanced timber palette. The extraordinary durability of the range makes it suitable for both domestic and commercial use, with fantastic warranties included. It's one of the toughest, most realistic looking vinyl floors on the market.



Easy to  
Install



Easy to  
Clean



Suitable for  
Wet Areas



Embossed  
Grain

Cover image:  
**PEARL GREY**







Featured image:  
**PEWTER OAK**

- 8 DESIGNS WITH AUTHENTIC WOODEN LOOK
- REGISTERED EMBOSSED FINISH
- RESIDENTIAL AND HEAVY COMMERCIAL USE
- SUPERIOR SPC / LVT CONSTRUCTION
- 5G LOCKING SYSTEM FOR EASY INSTALLATION
- IDEAL FOR LAYING OVER EXISTING HARD SURFACES
- NO ADHESIVE REQUIRED
- EACH PLANK IS 100% WATERPROOF (TESTED OVER 30 DAYS)
- MICRO BEVELLED EDGES
- SUITABLE FOR USE WITH UNDERFLOOR HEATING
- EXCELLENT SLIP RESISTANCE

Order FREE samples at [www.factory-direct-flooring.co.uk](http://www.factory-direct-flooring.co.uk)





---

## REAL WOOD LOOK, OUTSTANDING DURABILITY

Our Aqua Plank Ultra Range is finished with a four-sided micro bevel to provide a high-quality, remarkable real wood effect.

It's the closest you'll get to imitation wood, with the design also incorporating a true-to-grain real wood feel.

The Ultra Click flooring range has been manufactured to be very hard-wearing. It's versatility knows no bounds, holding up to everyday wear and tear with ease.

It's also been designed to withstand spills and moisture. Accidental spillages are something we all have to deal with everyday in our homes, but with this floor they're no longer an issue. Spills can be quickly wiped up with a little soapy water, for a stress-free clean up. Each of its planks have been individually waterproofed, as well as tried and tested under water for 30 days without any swelling.

Aqua Plank Ultra is the most durable flooring in our collection, guaranteed to withstand the test of time.

---

Featured image:  
**ORIGINAL OAK**

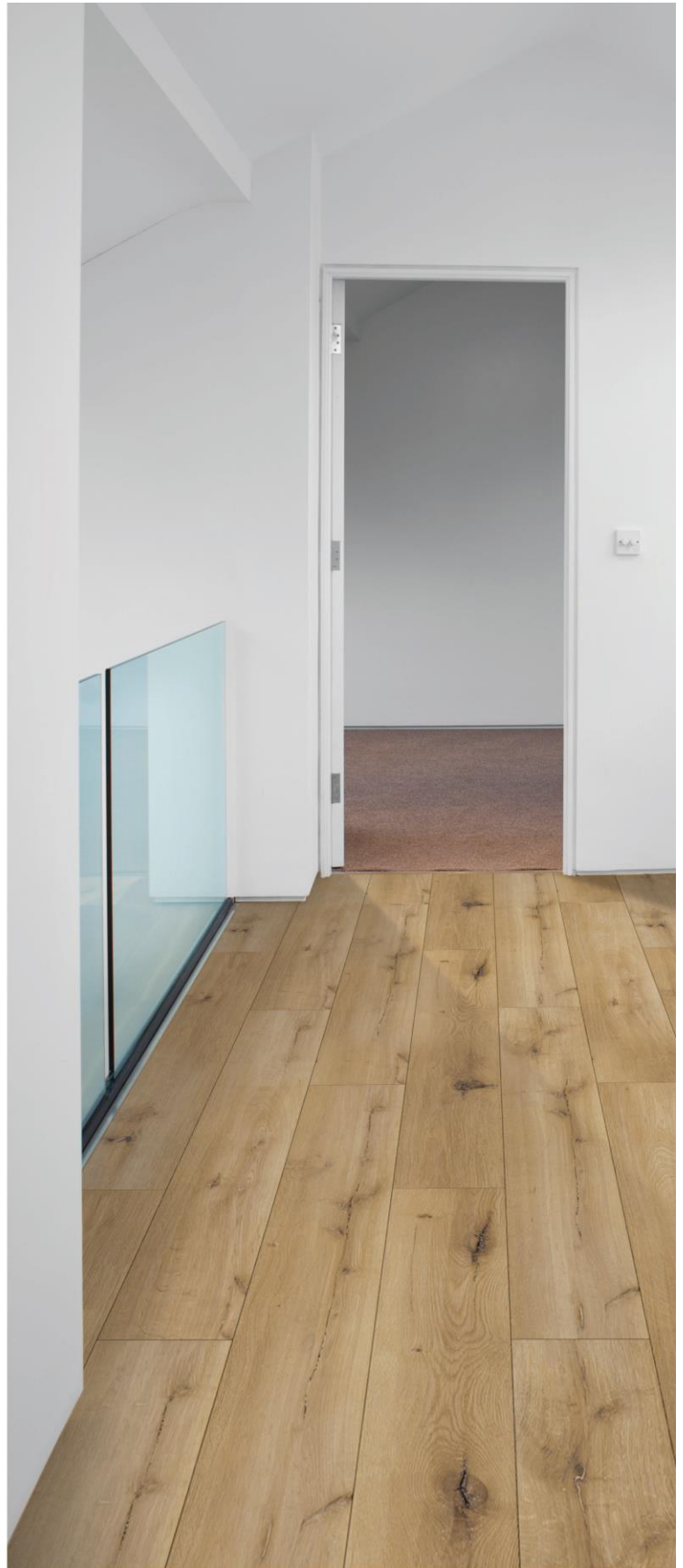



Order FREE samples at [www.factory-direct-flooring.co.uk](http://www.factory-direct-flooring.co.uk)

5





Featured image:  
**OSLO OAK**





---

## ROOM SUITABILITY

Aqua Plank Ultra is our most versatile flooring range. It's compatible with every room in your home, and even commercial environments such as shops and office refurbishments.

Underfloor heating is no challenge for this range of flooring, with most systems proving compatible.

The Aqua Plank Ultra range also provides excellent slip resistance, with a textured finish that provides additional grip. Unlike most flooring products sold today, this flooring holds up perfectly in areas that are prone to spillages.

Wherever you choose to install it, you can be sure the Aqua Plank Ultra range looks and performs as good as new for many years to come.

---



Above image:  
**CONTEMPORARY OAK**



Above image:  
**MANHATTAN OAK**



Featured image:  
**FLINT GREY**





Above image:  
**CHIC OAK**

## EXCEPTIONAL WARRANTIES

Our Aqua Plank Ultra collection comes with a 10 year commercial warranty and a 20 year residential warranty for complete peace of mind.

**10yr**  
COMMERCIAL  
WARRANTY

**20yr**  
RESIDENTIAL  
WARRANTY

Order FREE samples at [www.factory-direct-flooring.co.uk](http://www.factory-direct-flooring.co.uk)

9



**FACTORY DIRECT**  
FLOORING



## PRODUCT RANGE



CHIC OAK



CONTEMPORARY OAK



FLINT GREY



MANHATTAN OAK



ORIGINAL OAK

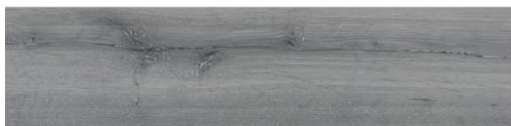

OSLO OAK



PEARL GREY



PEWTER OAK

## SPECIFICATION

<b>Thickness:</b>	4.5mm
<b>Wear Layer:</b>	0.55mm A/C 5 Class 33
<b>Surface Protection:</b>	Urethane Coating with Ceramic Bead Particles
<b>Plank Sizes:</b>	8 Planks, 180mm x 1220mm Total 1.7568m <sup>2</sup> per pack
<b>Warranties:</b>	10 Year Commercial 20 Year Residential



## EASY INSTALLATION

Aqua Plank Ultra has been designed to make installation quick and simple. Our unique 5G click system is by far the best locking system on the market today. This robust product means there's no need to use internal transition strips on areas up to 100m<sup>2</sup>. Perfect for fitting in larger, open plan rooms, offices or shops. Please see our installation guide on the page opposite.



CHIC OAK



CONTEMPORARY OAK

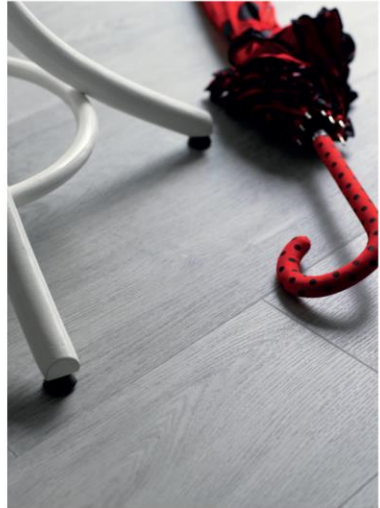

FLINT GREY



MANHATTAN OAK



ORIGINAL OAK



OSLO OAK



PEARL GREY



PEWTER OAK



**FACTORY DIRECT**  
FLOORING

Tel: 0330 100 0015  
Email [info@factory-direct-flooring.co.uk](mailto:info@factory-direct-flooring.co.uk)

Order FREE samples at  
[www.factory-direct-flooring.co.uk](http://www.factory-direct-flooring.co.uk)



**FACTORY DIRECT**  
FLOORING